

Y 293200

Y 293250

Skisse for Gnr.23 Bnr.567

X 6714400

Elvavegen, Meland Kommune

BK 06 og BK 07

Hus 33-34 og 35-36

X 6714350

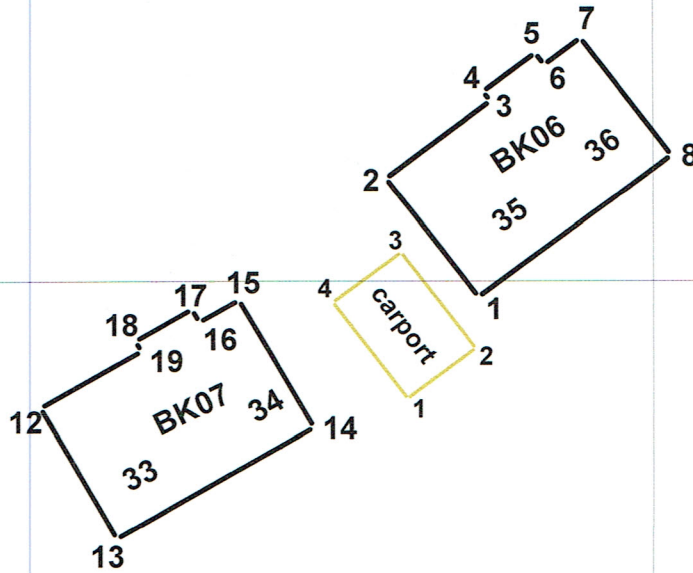

X 6714300

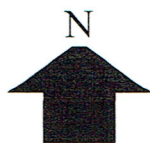

Skisse for Gnr.23 Bnr.567, Hus 33-34 og Hus 35-36
BK06 og BK07, Meland Kommune
Boligbygg Vest as
Dato: 16/12/19

Målestokk 1:500

Innmålingstjenester as *Ljerich K. Madsen*

ELV35

-00 FF
-01 000000000000 DDDDDDDDDDD VVVVVVVVVVV KKKKKKKKKKKK 00000000000
-02 SSSSSSSSSS KKKKKKKK NNNNNNNN TTTTTTTT TTTTTTTT II.III Bk MMMMMMM
-03 TTTTTTTTTT KKKKKKKK HHH.HHHH VVV.VVVV AAAA.AAA SS.SSS Bk MMMMMMM
-04 TTTTTTTTTT KKKKKKKK HHH.HHHH DDDD.DDD AAAA.AAA SS.SSS Bk MMMMMMM
-05 PPPPPPPPPP KKKKKKKK XXXXXXXX.XXX YYYYYYY.YYY ZZZZ.ZZZ Bk MMMMMMM
-06 PPPPPPPPPP KKKKKKKK PPPPPPPP.PPP AAAAAAA.AAA ZZZZ.ZZZ Bk MMMMMMM
-07 PPPPPPPPPP KKKKKKKK dXXXXXXX.XXX dYYYYYY.YYY dZZZ.ZZZ Bk MMMMMMM
-08 Epi E1 E2 E3 E4
-09_Pi Sammenheng FF MMMMMMM
-00 Leica Geosystems AG
-00 Instrument: GX1230 GG Måledato: 12.12.2019
-00 Målejobb: ELV35 Operatør:Kjersti K. Madsen
-00 Jobbeskrivelse:kontroll på carport,hus35,Bk06,Meland

05 M-Ref 0005		6709062.640	299001.734	97.655	0.000
05 1	5001	6714342.001	293233.757	35.309	0.035
05 2	5001	6714345.417	293238.228	35.305	0.015

8desHus35

05	GRENSE1	4056	6714338.480	293233.020	0.000	
05	GRENSE2	4056	6714359.390	293222.880	0.000	
05	GRENSE3	4056	6714367.370	293235.550	0.000	
05	GRENSE4	4056	6714362.950	293238.870	0.000	
05	GRENSE5	4056	6714354.220	293245.470	0.000	
05	GRENSE6	4056	6714349.630	293248.900	0.000	
05	GRENSE7	4056	6714341.220	293237.800	0.000	
05	ASALT2	2000	6714338.545	293232.974	32.438	
05	ASALT3	2000	6714341.301	293237.770	32.305	
05	ASALT4	2000	6714341.332	293237.790	32.314	
05	ASALT5	2000	6714343.891	293241.716	32.115	
05	ASALT6	2000	6714345.830	293244.077	32.043	
05	ASALT7	2000	6714348.420	293246.849	31.945	
05	ASALT8	2000	6714350.054	293248.505	31.866	
05	ASALT9	2000	6714351.069	293249.524	31.848	
05	ASALT10	2000	6714348.030	293252.626	31.962	
05	ASALT11	2000	6714346.093	293250.652	32.005	
05	ASALT12	2000	6714343.340	293247.847	32.038	
05	ASALT13	2000	6714341.202	293245.267	32.104	
05	ASALT14	2000	6714338.927	293241.819	32.155	
05	ASALT15	2000	6714336.817	293239.165	32.197	
05	ASALT16	2000	6714335.404	293238.083	32.248	
05	ASALT17	2000	6714333.936	293237.626	32.255	
05	SKULDER1	2001	6714343.228	293239.272	32.193	
05	SKULDER2	2001	6714344.485	293241.009	32.021	
05	SKULDER3	2001	6714345.548	293242.687	32.006	
05	SKULDER4	2001	6714347.244	293244.759	31.921	
05	SKULDER5	2001	6714349.032	293246.904	31.850	
05	SKULDER6	2001	6714349.776	293247.878	31.852	
05	SKULDER7	2001	6714350.290	293248.305	31.759	
05	SINGEL1	2002	6714350.789	293247.543	31.312	
05	SINGEL2	2002	6714349.688	293246.374	31.353	
05	SINGEL3	2002	6714348.130	293244.531	31.354	
05	SINGEL4	2002	6714346.728	293242.662	31.332	
05	SINGEL5	2002	6714346.139	293241.721	31.409	
05	SINGEL6	2002	6714346.468	293240.374	31.358	
05	SINGEL7	2002	6714345.694	293238.330	31.431	
05	HUSNY1	5001	6714354.040	293245.435	34.668	
05	HUSNY2	5001	6714358.528	293251.302	34.878	
05	HUSNY3	5001	6714366.566	293245.198	34.923	
05	HUSNY4	5001	6714367.350	293244.631	34.916	
05	HUSNY5	5001	6714362.898	293238.621	34.781	
05	HUSNY6	5001	6714362.240	293239.111	34.998	
05	HUSNY7	5001	6714348.776	293238.342	34.879	
05	HUSNY8	5001	6714357.021	293232.226	34.925	
✓	05	NYCAR1	5001	6714342.042	293233.733	35.429
✓	05	NYCAR2	5001	6714345.426	293238.235	35.420
05	NYCAR3	5001	6714351.948	293233.321	35.443	
05	NYCAR4	5001	6714348.568	293228.808	35.436	