

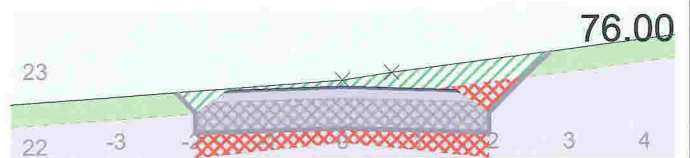

Gnr.51 bnr.104-Landsvit
SITUASJONSPLAN
12.02.2016
Målestokk 1:500
Medaas Oppmåling

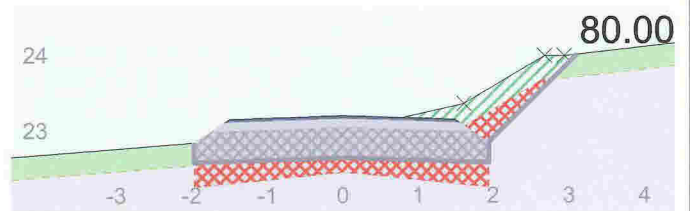
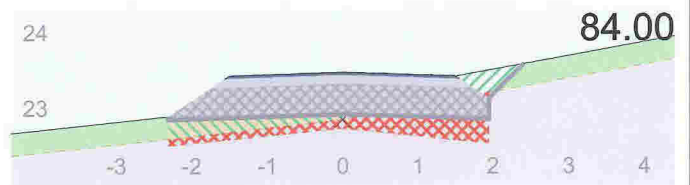
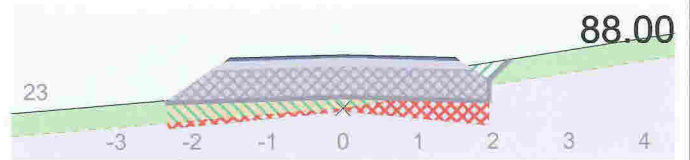
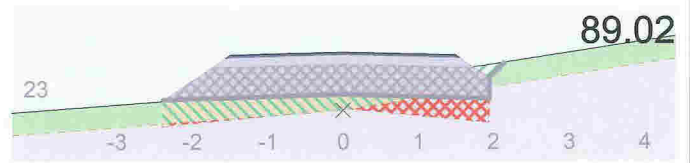
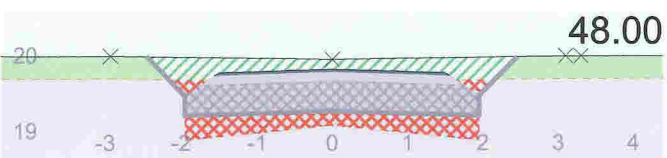
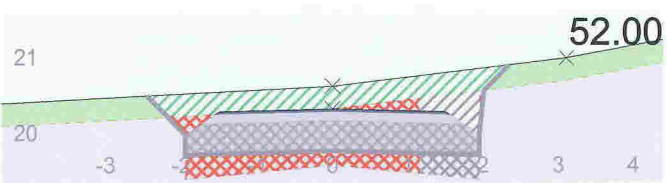
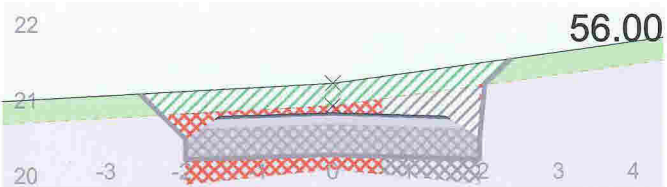
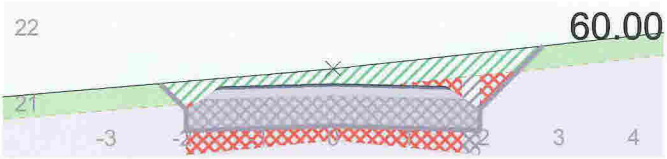
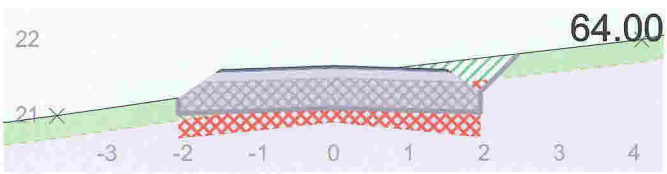
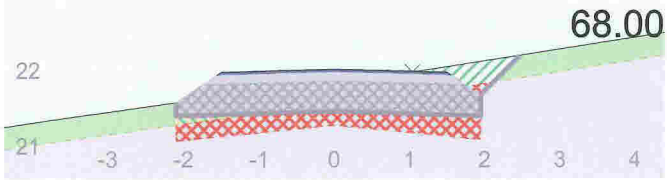
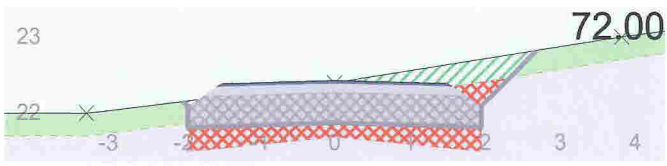

Veg til Gbnr. 51/104- Landsvik

Tverrprofil

Medaas Oppmåling

Lillevika 47, 5914 Isdalste
Tlf: 48287186, E-Post: kjameda@online.no

Tegnet av km	Saksbehandler
Sidemannskontnr.	Prosjektansvarlig
Dato 05.02.2016	Målestokk 1: 100 1: 100
Prosj.nr.	Rev.
Tegn.nr. 2	

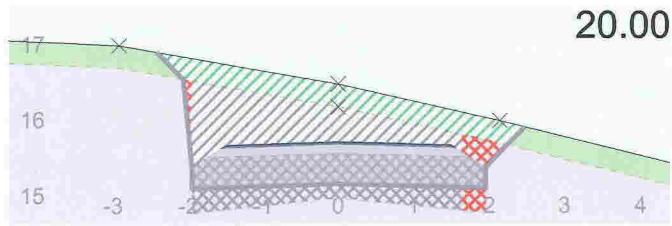

20.00

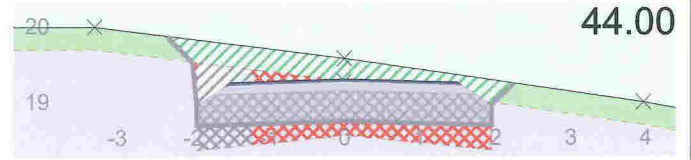

44.00

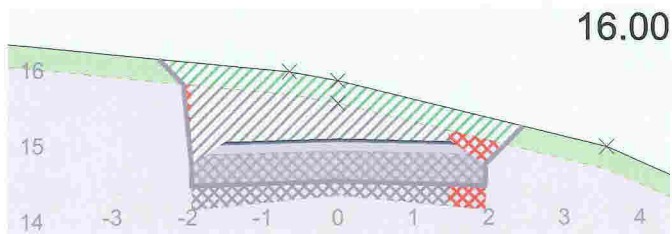

16.00

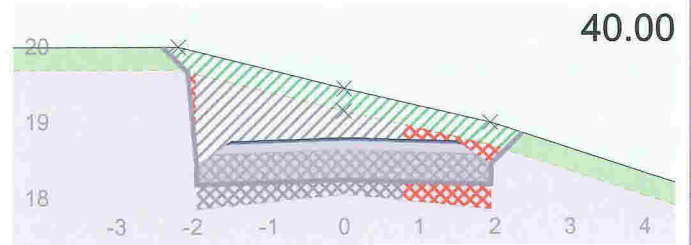

40.00

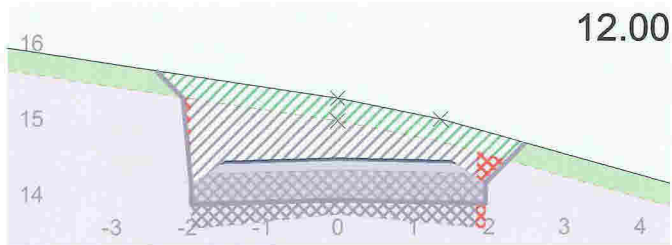

12.00

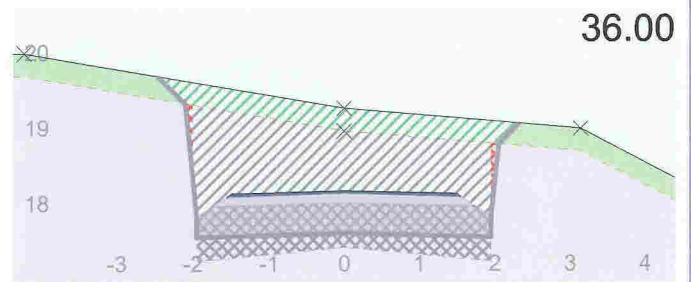

36.00

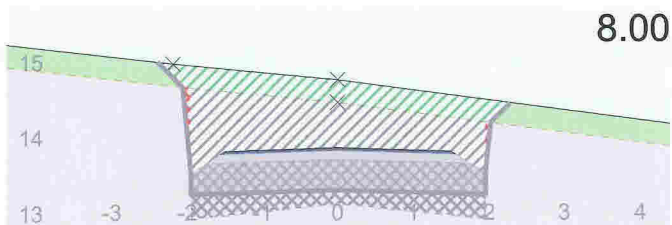

8.00

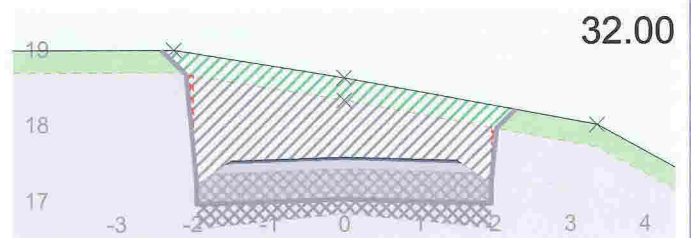

32.00

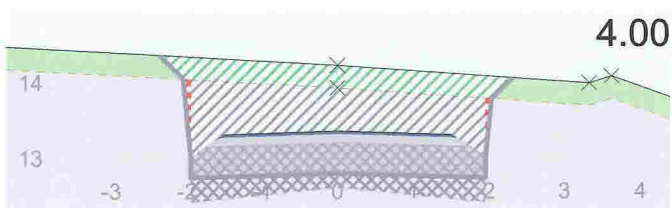

4.00

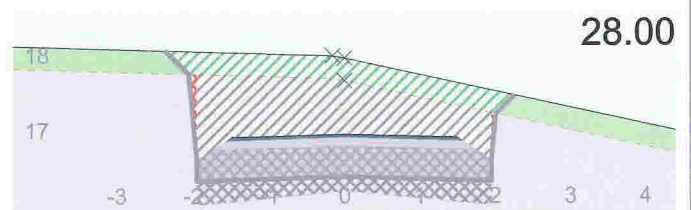

28.00

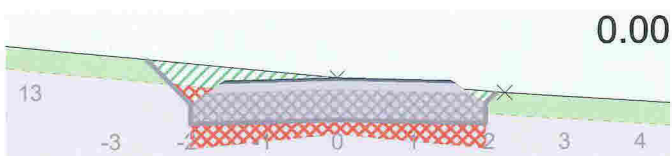

0.00

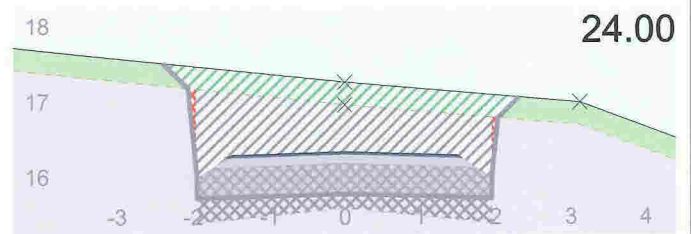

24.00

Veg til Gbnr. 51/104- Landsvik

Tverrprofil

Medaas Oppmåling

Litevika 47, 5914 Isdalstø
Tlf: 48287186, E-Post: kjameda@online.no

Tegnet av km	Saksbehandler
Sidemannskontr.	Prosjektansvarlig
Dato 05.02.2016	Målestokk 1: 100 1: 100
Prosj.nr.	Rev.
Tegn.nr. 1	

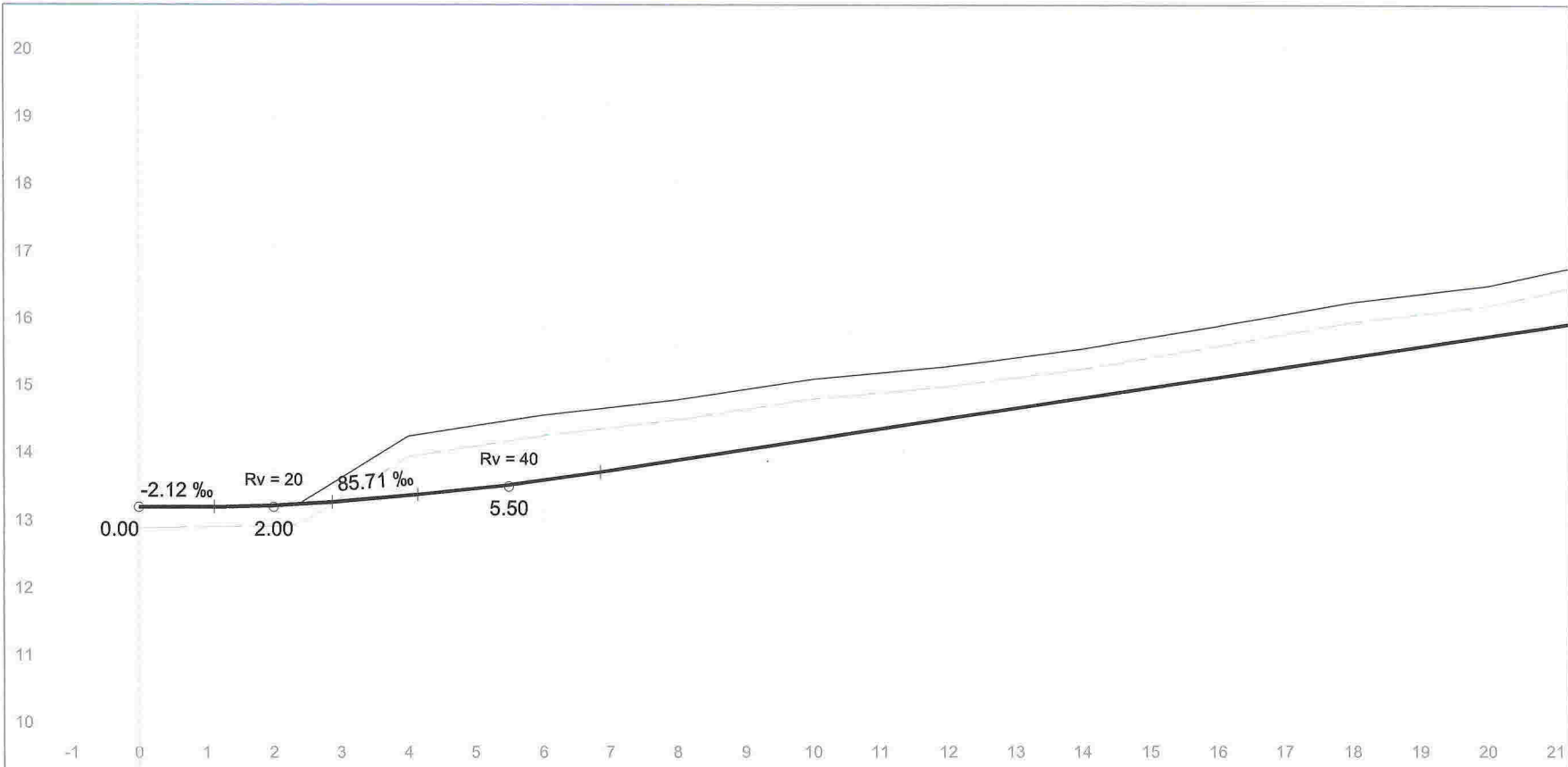

Vert.kurv.	-2.12‰	Rv = 20	85.71‰	Rv = 40	153.62‰	
Hor.kurv.			R = 10		R = -12	
Profil h.	13.20			14.19		15.73
Terreng h.	13.20			15.10		16.48

Veg til Gbnr. 51/104- Landsvik Lengdeprofil Medaas Oppmåling <small>Litlevika 47, 5914 Isdalstø Tlf: 48287186, E-Post: kjameda@online.no</small>	Tegnet av	Saksbehandler
	km	
	Sidemannskontr.	Prosjektansvarlig
	Dato	Målestokk
	05.02.2016	1: 100
	Prosj.nr.	1: 100
	Tegn.nr.	Rev.
	1	

ES

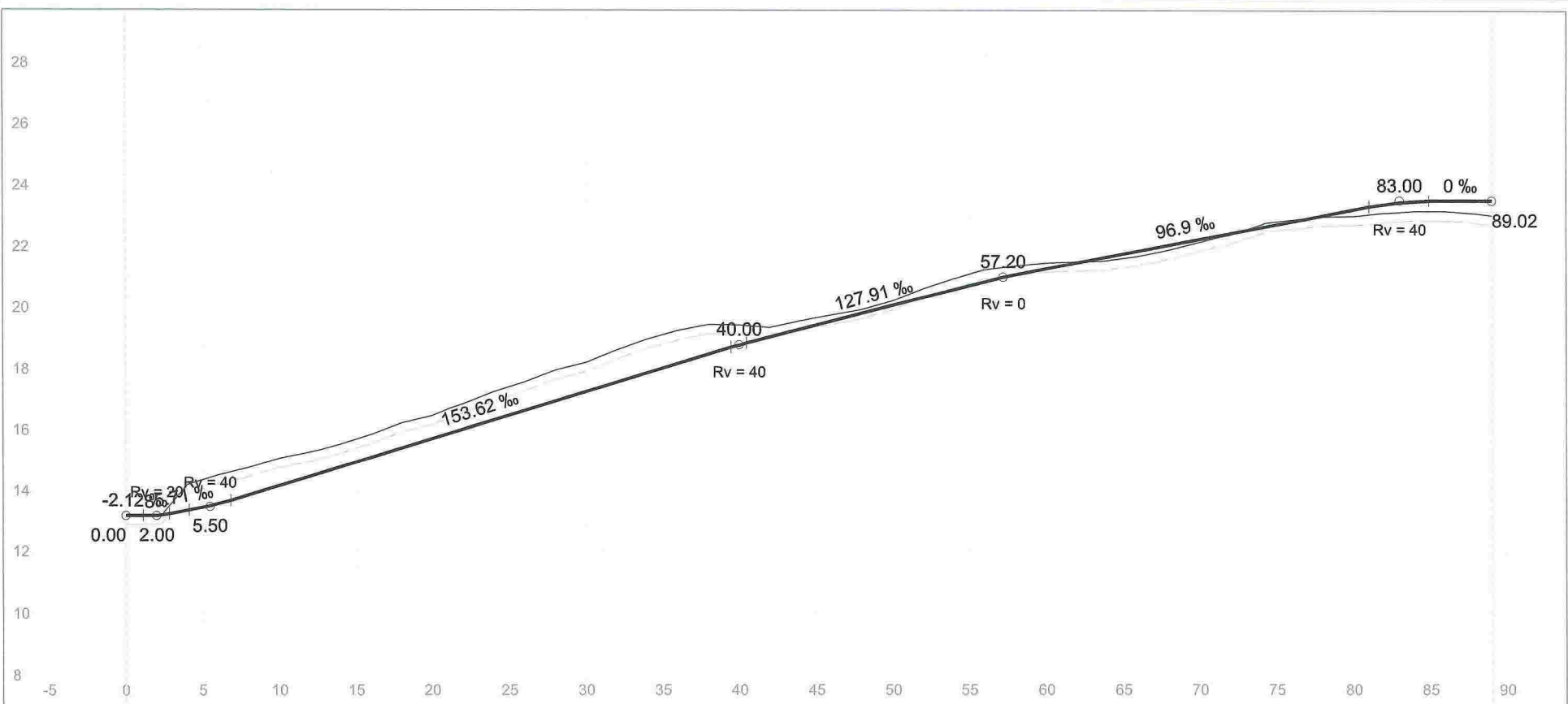

Vert.kurv.	-2.12‰		85.71‰		153.62‰										127.91‰		96.9‰		0‰	
Hor.kurv.	R = 10		R = -12		R = -18										R = 14		R = -19		R = -10	
Profil h.	13.20		14.19		15.73		17.26		18.80		20.08		21.27		22.24		23.21		23.50	
Terreng h.	13.20		15.10		16.48		18.23		19.45		20.24		21.47		22.15		23.01		23.03	

Veg til Gbnr. 51/104- Landsvik Lengdeprofil Medaas Oppmåling <small>Litlevika 47, 5914 Isdalstø Tlf: 48287186, E-Post: kjameda@online.no</small>	Tegnet av	Saksbehandler	
	km		
	Sidemannscontr.	Prosjektansvarlig	
	Dato	Målestokk	
	05.02.2016	1: 400	
Prosj.nr.	1: 200		
Tegn.nr.	1	Rev.	

Lima VVA 4.1.1.2.5 (Medaas Oppmåling og Minnmaskin(15)), Parsell: Veg-Alt2

E4

6724655
 6724650
 6724645
 6724640
 6724635
 6724630
 6724625
 6724620
 6724615
 6724610
 6724605
 6724600
 6724595
 6724590
 6724585
 6724580
 6724575
 6724570
 6724565
 6724560
 6724555
 6724550
 6724545

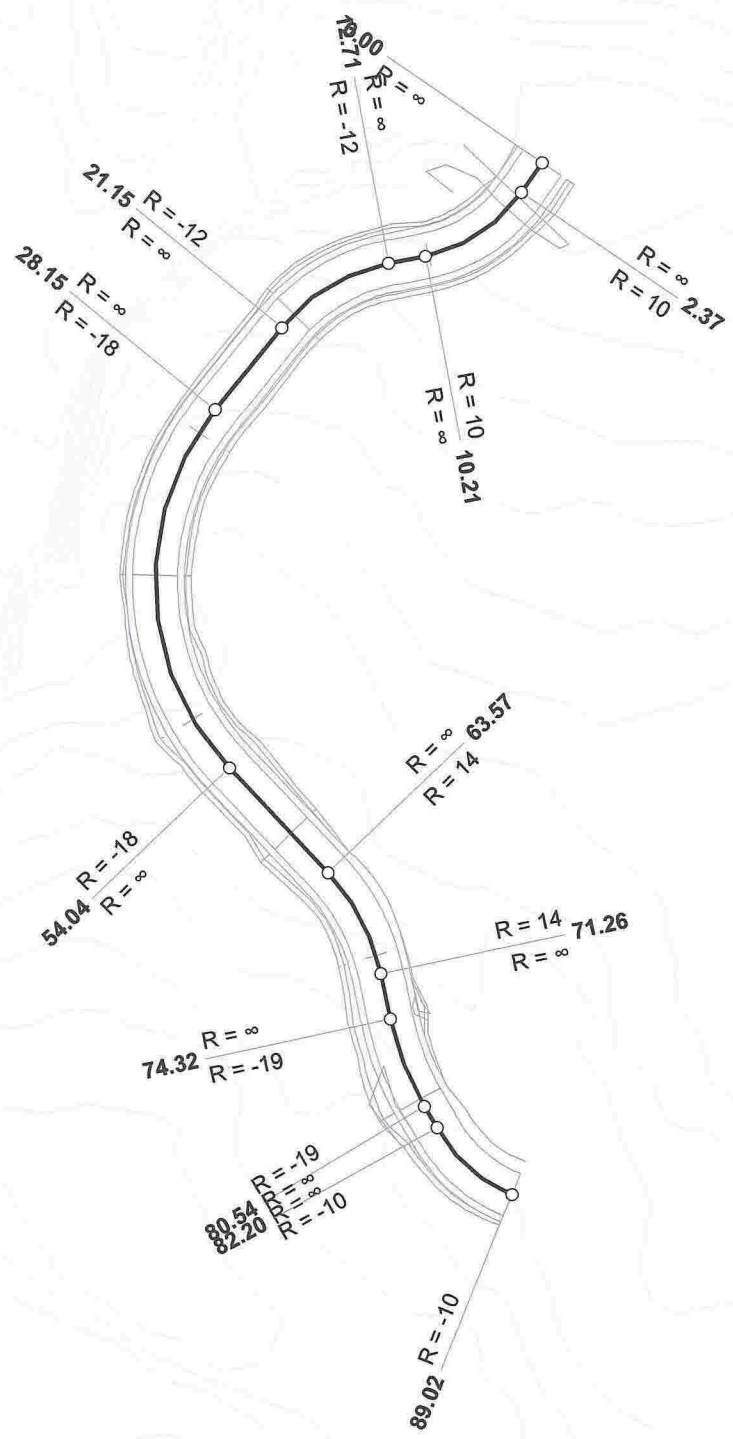

284670284675284680284685284690284695284700284705284710284715284720284725284730284735284740284745

Veg til Gbnr. 51/104- Landsvik Horisontalplan	Tegnet av km	Saksbehandler
	Sidemannskonstr.	Prosjektansvarlig
Medaas Oppmåling Lillevika 47, 5914 Isdalstø Tlf: 48287186, E-Post: kjameda@online.no	Dato 05.02.2016	Målestokk 1: 500
	Prosj.nr.	1: 500
	Tegn.nr. 1	Rev.

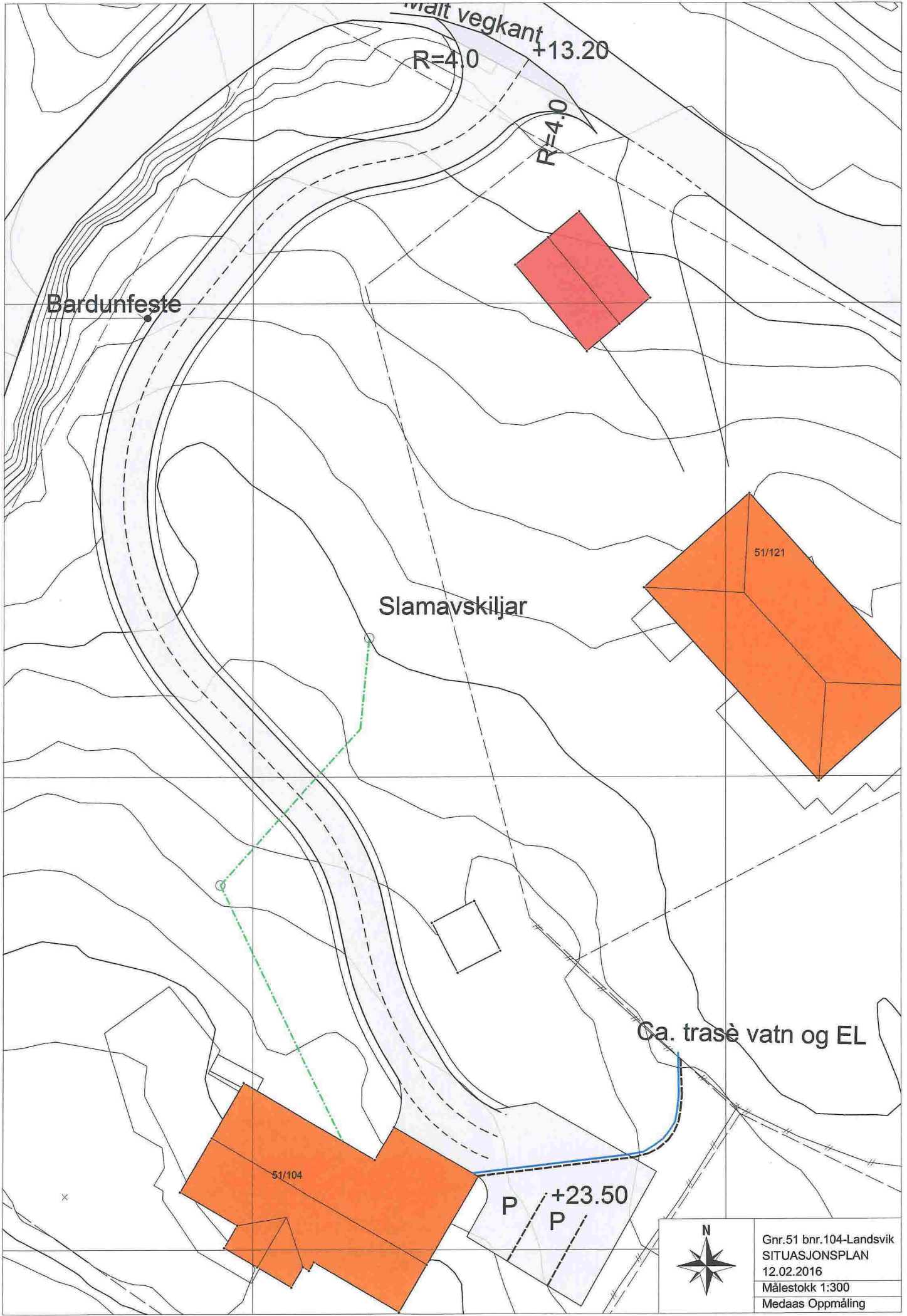

Bardunfeste

vegt kant +13.20

R=4.0

R=4.0

Slamavskiljar

51/121

51/104

P +23.50
P

Ca. trasè vatn og EL



Gnr.51 bnr.104-Landsvik
 SITUASJONSPLAN
 12.02.2016
 Målestokk 1:300
 Medaas Oppmåling

E1-7

E1

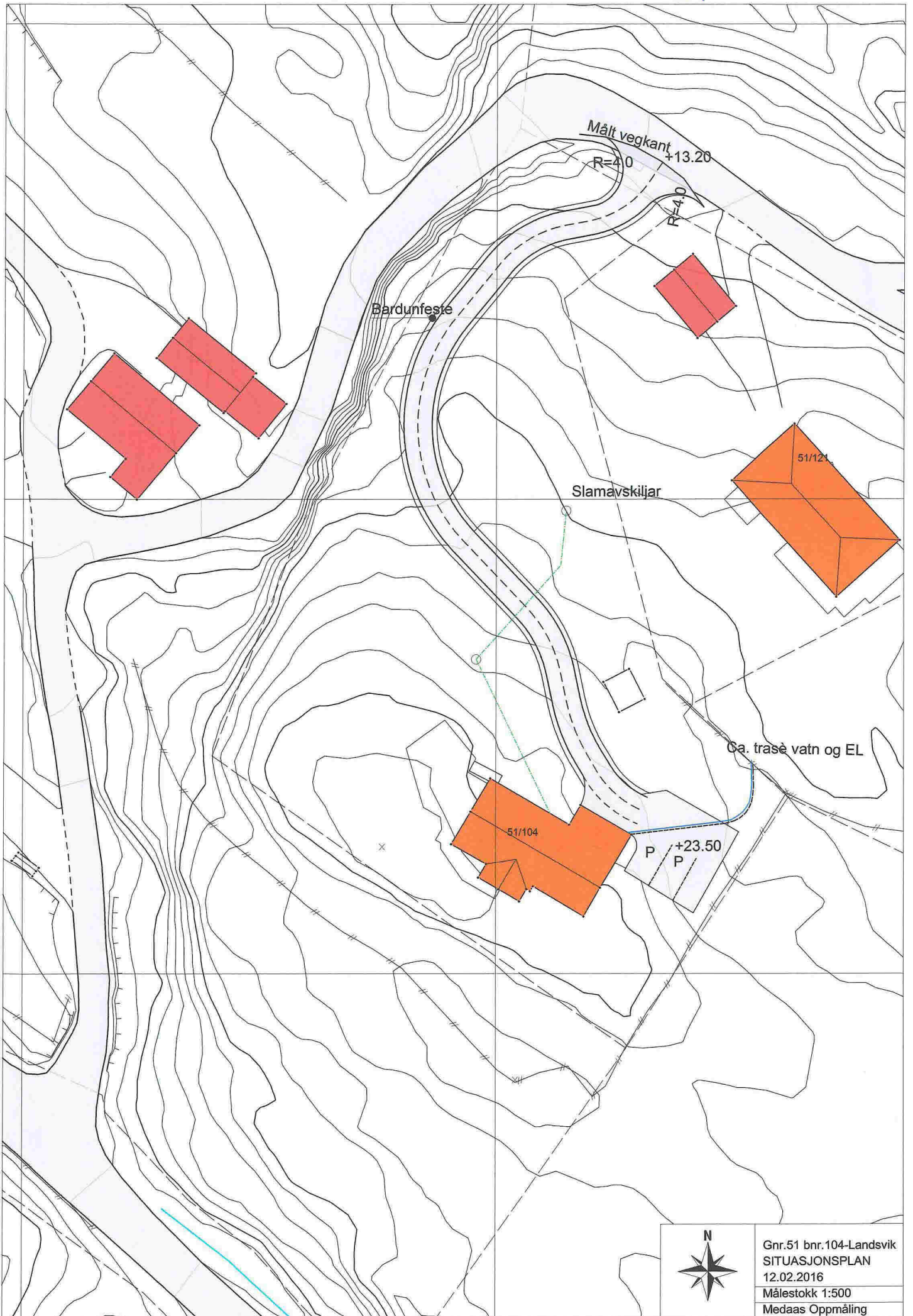

Gnr.51 bnr.104-Landsvik
SITUASJONSPLAN
12.02.2016
Målestokk 1:500
Medaas Oppmåling

D1

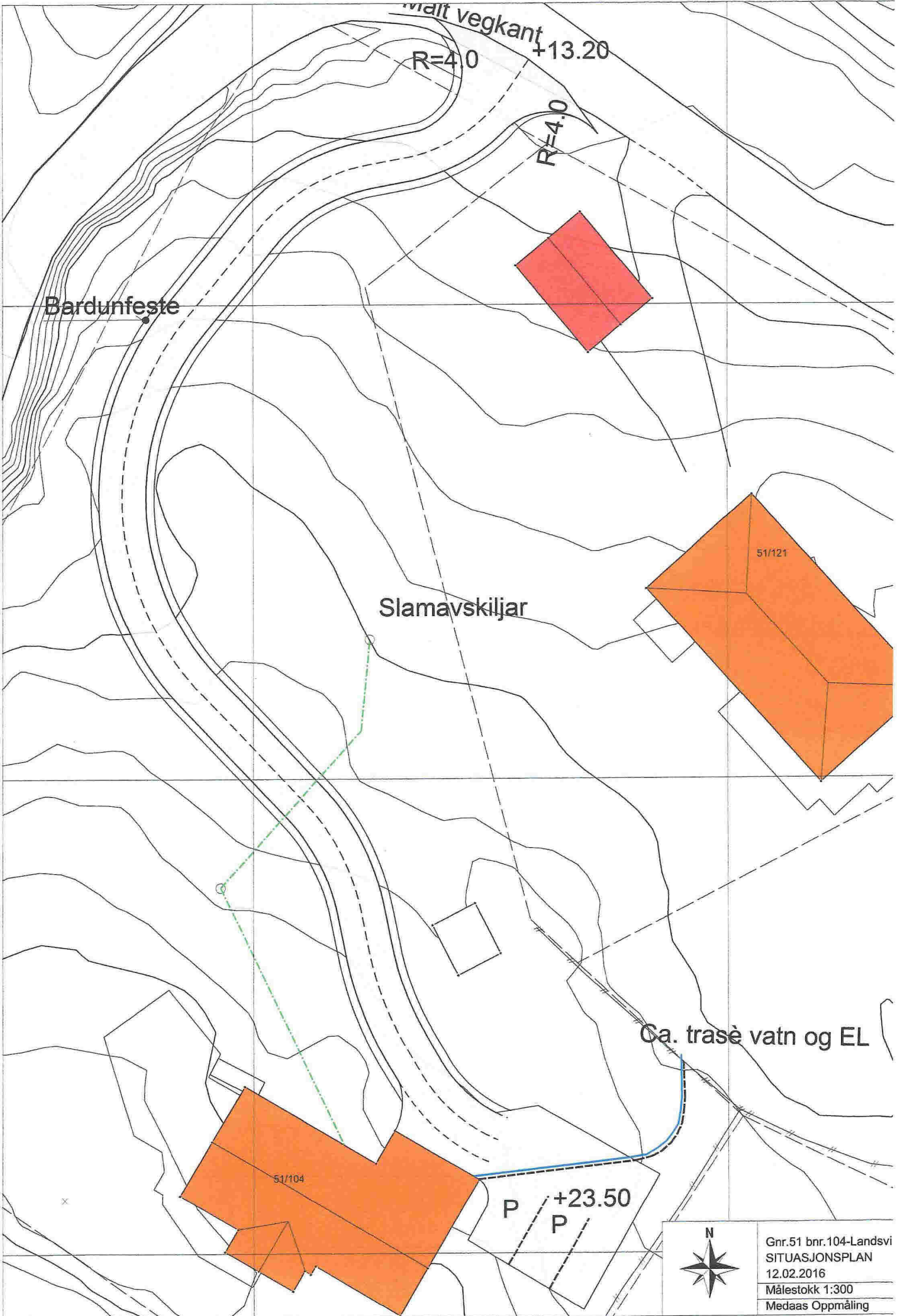

Gnr.51 bnr.104-Landsvi
SITUASJONSPLAN
12.02.2016
Målestokk 1:300
Medaas Oppmåling